



36 Dresser Road

Prestwood
Buckinghamshire
HP16 0NA

Price £225,000

- 2 bedroom, age restricted bungalow (60+)
- Tucked away location
- Private rear garden
- Allocated parking
- No onward chain



PROPERTY FACTS

36 Dresser Road is a retirement property (60+), situated at the end of a cul-de-sac in a small development of similar bungalows. The property is in a neat and tidy condition with a pleasant lounge overlooking the enclosed rear garden, a well fitted kitchen, gas central heating and sealed unit double glazed windows. There is a private, enclosed rear garden and an allocated parking space at the front.

LOCATION FACTS

Prestwood village centre has an excellent range of day-to-day facilities available including a variety of local shops, ie Butchers, Bakers, Newsagents, Post Office, Chemist, Florist and Supermarkets, together with Doctors' and Dentists' surgeries. Nearby Great Missenden also offers a main line rail link into Central London which is ideal for the commuter. For more extensive requirements both High Wycombe and Amersham are approximately 4/5 miles from Prestwood.

ACCOMMODATION

Briefly accommodation comprises: Entrance hall | Kitchen | Sitting room | Two bedrooms | Bathroom | Private rear garden | Allocated parking

ADDITIONAL INFORMATION

Council Tax Band C | EPC Band D | Local Authority; Chiltern District

DIRECTIONS

From our offices in Prestwood follow the Wycombe Road towards Great Kingshill, turning left into Hildreth Road, second left into Dresser Road and the property will be found at the end on the right hand side.

Whilst these particulars are believed to be correct they are not guaranteed by the vendor or the vendor's agents "Wye Country" and neither does any person have any authority to make or give any representation or warranty on their behalf. Prospective purchasers must satisfy themselves by inspection or otherwise as to the correctness of each statement contained in these particulars. All measurements are approximate and the particulars do not constitute, or form part of an offer or a contract.

Room Dimensions
Bed 1 11'1" (+bay) x 8'
Bed 2 6'4" x 7'5"
Kitchen 9'6" x 5'7"
Living Room 11' x 13'3"

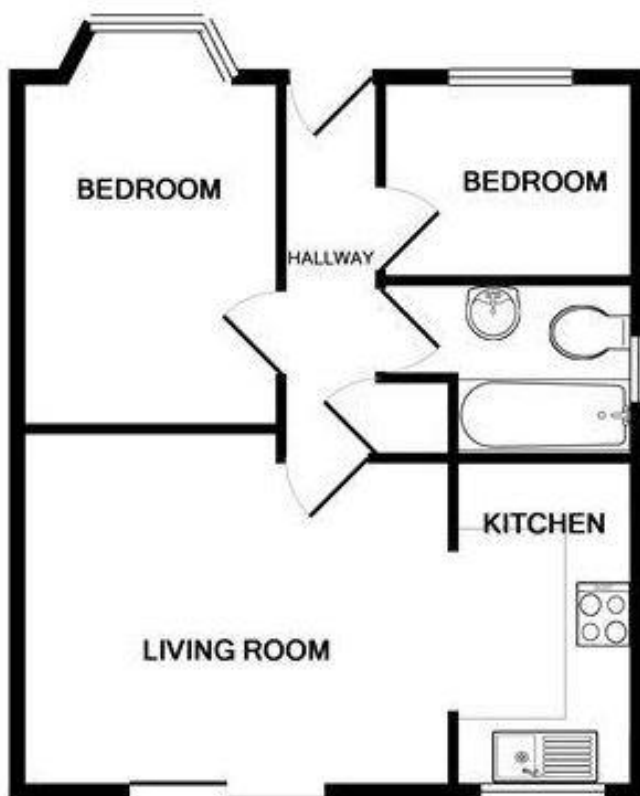

Whilst every attempt has been made to ensure the accuracy of the floor plan contained here, measurements of doors, windows, rooms and any other items are approximate and no responsibility is taken for any error, omission, or mis-statement. This plan is for illustrative purposes only and should be used as such by any prospective purchaser. The services, systems and appliances shown have not been tested and no guarantee as to their operability or efficiency can be given
Made with Metropix ©2013